



BORNEMANN Boring cutter "TunnelCut"

Applications

- Manually mill bores as required for water drainage systems, cable ducts and suspension lugs in foundry patterns as applied in full mould casting (lost foam casting) and a host of other applications
- Boring diameter: 30 to 150 mm
- Cut straight or bent bore holes

Milling materials

- Hard, brittle, expanded plastics:
- Polystyrene (PS) up to 30 kg/m³
 - Polyurethane (PU) up to 100 kg/m³
 - and others

Advantages

- Finish manual milling jobs in no time flat
- Finish manual milling jobs effortlessly
- Precision milling results
- Super smooth and clean finish
- Easy to use
- Effortlessly mill even glued, rigid foam panels
- The bore core is machined roughly and can be easily sucked away.

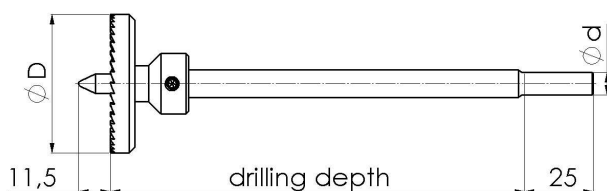

Ordering specifications / dimensions

Article-no.	Description
BW 500.549	TunnelCut, ØD 30 mm
BW 500.535	TunnelCut, ØD 35 mm
BW 500.350	TunnelCut, ØD 40 mm
BW 500.537	TunnelCut, ØD 45 mm
BW 500.351	TunnelCut, ØD 50 mm
BW 500.360	TunnelCut, ØD 55 mm
BW 500.343	TunnelCut, ØD 60 mm
BW 500.361	TunnelCut, ØD 65 mm
BW 500.345	TunnelCut, ØD 70 mm
BW 500.365	TunnelCut, ØD 75 mm
BW 500.352	TunnelCut, ØD 80 mm
BW 500.536	TunnelCut, ØD 85 mm
BW 500.353	TunnelCut, ØD 90 mm
BW 500.512	TunnelCut, ØD 95 mm
BW 500.354	TunnelCut, ØD 100 mm
BW 500.513	TunnelCut, ØD 105 mm
BW 500.514	TunnelCut, ØD 110 mm
BW 500.558	TunnelCut, ØD 115 mm
BW 500.517	TunnelCut, ØD 120 mm
BW 500.518	TunnelCut, ØD 125 mm
BW 500.515	TunnelCut, ØD 130 mm
BW 500.357	TunnelCut, ØD 150 mm
BW 500.370	Drilling spindle for drilling depth 60 mm, Ød 8 mm
BW 500.371	Drilling spindle for drilling depth 100 mm, Ød 8 mm
BW 500.372	Drilling spindle for drilling depth 150mm, Ød 8 mm
BW 500.373	Drilling spindle for drilling depth 200 mm, Ød 8 mm

Other dimensions on request.

Technical modifications reserved. Status November 2013