



# BORNEMANN

## BW Surface cutter head

### Applications

- Trimming by CNC surface milling for blocks, boards and patterns

### Milling materials

Hard, brittle, expanded plastics:

- Polystyrene (PS, XPS) up to 50 kg/m<sup>3</sup>
- Polyurethane (PU) up to 120 kg/m<sup>3</sup>
- and others

### Advantages

- Fast trimming by CNC surface milling for blocks, boards and patterns
  - allows for the high productivity
- Very good quality finishes
  - make manual rework unnecessary
  - provide high planning reliability ensuring quality products
- Keep close tolerances
  - provides high planning reliability ensuring quality products
- Continuous, direct suction effectively removes chips internally through the hollow cutter by utilising a hollow-shaft motor with a suction machine Bornemann 960
  - assuring a high rate of chip removal
- Special hardening guarantees a long service life
  - ensures high economic efficiency
- Dynamically balanced
  - precise concentricity
- Also available with integrated ISO or HSK adaptor.

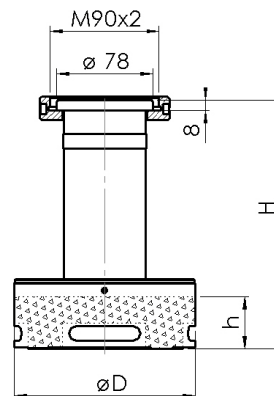

### Ordering specifications / dimensions

Article-no.	Ø D [mm]	H [mm]	h [mm]
BW 500.150.40.100	150	100	40
BW 500.150.40.200	150	200	40
BW 500.150.40.300	150	300	40

Other dimensions on request.

Technical modifications reserved. Status November 2013